

# T-300UH



**GARDNER DENVER**  
WATER JETTING  
SYSTEMS, INC.

Pressures to 40,000 PSI  
Flows to 4.0 GPM • Power to 100 HP

## Easy & Affordable Ultra-High

### Features:

- ◆ Inline fluid end design.
- ◆ Pressure range to 40,000 PSI.
- ◆ Flow rates from 1.3 GPM to 4.0 GPM.
- ◆ Maximum frame load of 7,000 Lbs. / 3178 Kg.
- ◆ Field proven design.
- ◆ Easy field maintenance.
- ◆ Stainless steel fluid end construction.
- ◆ High volumetric efficiency for maximum horsepower utilization.
- ◆ Autofrettaged fluid cylinders and valve assemblies.
- ◆ Rigorously subjected to full load testing.
- ◆ Manufactured on state-of-the-art machinery.

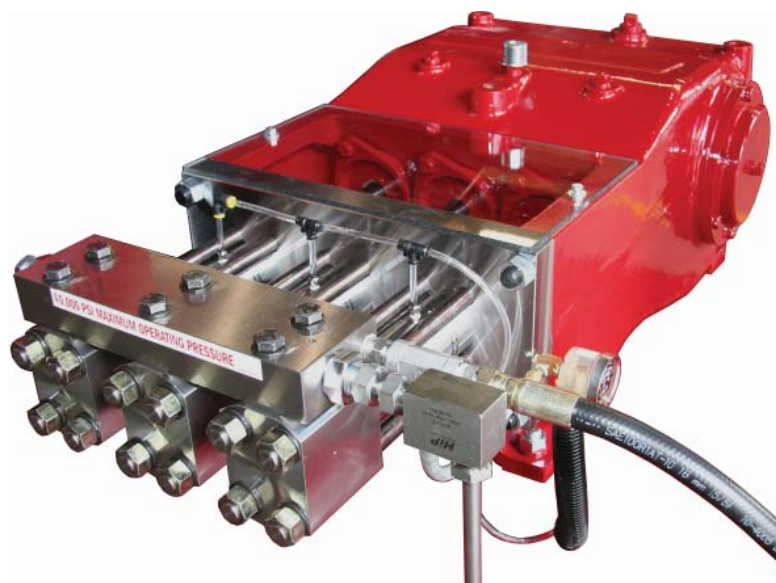

### Applications:

- ◆ Water Blasting
- ◆ Surface Preparation
- ◆ Hydrostatic Testing

### Performance Specifications:

T-300UH	PLUNGER DIA.	MAX. PRESSURE		FLOW					
		PSI	Bar	200 RPM		400 RPM		500 RPM	
				GPM	LPM	GPM	LPM	GPM	LPM
	0.472" - 12mm	40K	2758	1.3	4.92	2.7	10.2	4.0	15.1

Note: All flows are based on 100% volumetric efficiency.

**Stroke: 3" / 76 mm • Max. Speed: 600 RPM • Weight: 810 lbs. / 368 Kg**



**GARDNER DENVER WATER JETTING SYSTEMS, INC.**

Partek • Liqa-Blaster • CRS Power Flow • Jetting Systems • American Water Blaster

# T-300UH

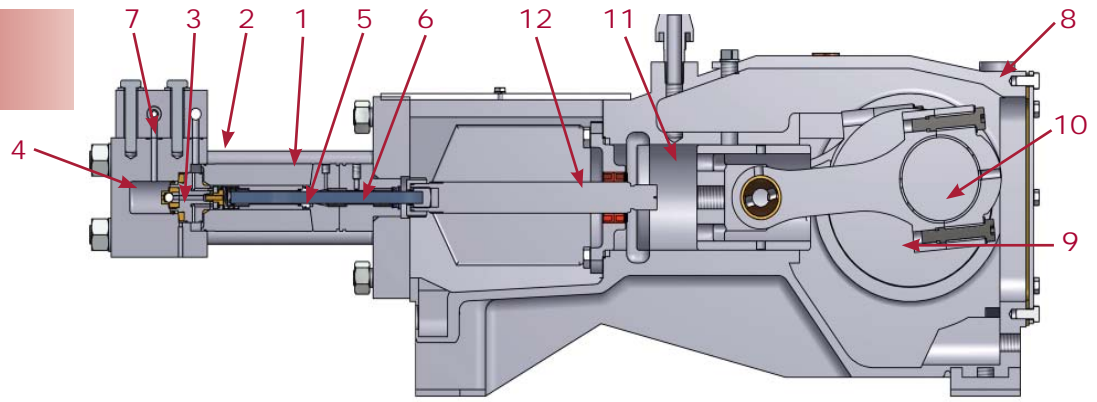

## Fluid End

1. Fluid Cylinder Body: Three cylinders machined from hardened stainless steel and autofrettaged for extended life.
2. Suction Manifold: Hard, anodized aluminum. Also available in stainless for salt water applications.
3. Valve Assembly: Hardened stainless steel, autofrettaged for extended life. Valves are spring-loaded for positive closing with a common seat used for both suction and discharge valves.
4. Discharge Manifold: Manufactured from precipitation hardened stainless steel.
5. Plungers: Collet style and made of tungsten carbide.
6. Plunger Packing: Carbon filled Teflon™ and polyethylene base, spring-loaded, self-adjusting and easily replaceable from the rear of the stuffing box. Force-fed water provides lubrication and cooling.
7. Pressure Relief: Pressure safety head assembly (two rupture discs), mounted to the discharge manifold.

## Power End

8. Power Frame: Manufactured from a single piece casting of high strength gray cast iron.
9. Crankshaft: Single extended steel with tapered roller bearings to minimize side thrust load.
10. Connecting Rods: Ductile iron with automotive type split insert bearings.
11. Crossheads: Large, piston type constructed of gray iron.
12. Diaphragm Seals: Installed with o-rings or gaskets and neoprene oil seals.

*Bearings and crossheads are oil lubricated with a combined splash gravity system that insures adequate circulation at speeds as low as 200 RPM.*

## Dimensions:

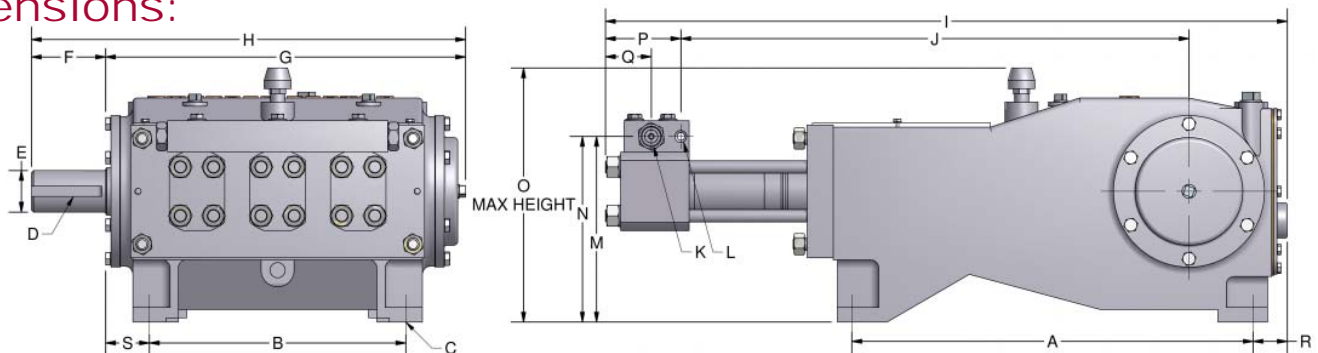

	A	B	C	D	E	F	G	H	I	J	K	L	M	N	O	P	Q	R	S
In.	24 <sup>1</sup> / <sub>4</sub>	15 <sup>1</sup> / <sub>2</sub>	1 <sup>3</sup> / <sub>16</sub>	5/8	2 <sup>1</sup> / <sub>2</sub>	4 <sup>1</sup> / <sub>2</sub>	21 <sup>3</sup> / <sub>4</sub>	26 <sup>1</sup> / <sub>4</sub>	41 <sup>3</sup> / <sub>16</sub>	30 <sup>11</sup> / <sub>16</sub>	1" MP	1/2" NPT	11 <sup>3</sup> / <sub>16</sub>	11 <sup>3</sup> / <sub>16</sub>	15 <sup>5</sup> / <sub>16</sub>	4 <sup>9</sup> / <sub>16</sub>	2 <sup>3</sup> / <sub>4</sub>	2 <sup>1</sup> / <sub>16</sub>	2 <sup>5</sup> / <sub>8</sub>
mm	616	394	21	16	64	114	553	667	1046	780			284	284	389	116	70	52	67

Your local distributor/representative is:

GARDNER DENVER WATER  
JETTING SYSTEMS, INC.



GARDNER DENVER WATER JETTING SYSTEMS, INC.

Partek • Liqua-Blaster • CRS Power Flow • Jetting Systems • American Water Blaster