

TY-375S



Pressures to 15,000 PSI
Flows to 60 GPM • Power to 300 HP

Fast & Affordable Convertibility

Features:

- ◆ Pressure/flow convertibility from well of pump. Does not require unbolting and retorquing.
- ◆ No valve change required.
- ◆ Sectionalized "L" fluid end design.
- ◆ Pressure range of 4,000 to 15,000 PSI.
- ◆ Flow rates from 8 GPM to 60 GPM.
- ◆ Maximum frame load of 19,500 Lbs. / 8845 Kg for single speed.
- ◆ Rugged elastomer inserted valves provide superior service in "dirty" water applications.
- ◆ Flanged suction and discharge ports (both ends).
- ◆ Field proven design. Easy field maintenance.
- ◆ Stainless steel fluid end construction.
- ◆ Rigorously subjected to full load testing.
- ◆ Manufactured on state-of-the-art machinery.



Applications:

- ◆ Water Blasting
- ◆ Chemical Injection
- ◆ Hydrostatic Testing
- ◆ Reverse Osmosis
- ◆ Fluid Transfer
- ◆ Oilfield Services
- ◆ Process
- ◆ Homogenization

Performance Specifications:

| | PLUNGER DIA. | MAX. PRESSURE | | FLOW | | | | | |
|------------------|--------------|---------------|------|---------|-----|---------|-----|---------|-----|
| | | PSI | Bar | 200 RPM | | 400 RPM | | 500 RPM | |
| | | | | GPM | LPM | GPM | LPM | GPM | LPM |
| TY-375S at 150HP | 1.06" - 26mm | 12K | 828 | 8.6 | 33 | 17.3 | 65 | 21.6 | 82 |
| | 1.25" - 32mm | 8K | 552 | 12.0 | 45 | 23.9 | 91 | 29.9 | 113 |
| | 1.56" - 40mm | 5K | 345 | 18.7 | 71 | 37.4 | 142 | 46.7 | 177 |
| | 1.75" - 44mm | 4K | 276 | 23.4 | 89 | 46.9 | 178 | 58.6 | 222 |
| TY-375S at 200HP | 1.06" - 26mm | 15K | 1034 | 8.6 | 33 | 17.3 | 65 | 21.6 | 82 |
| | 1.25" - 32mm | 11K | 759 | 12.0 | 45 | 23.9 | 91 | 29.9 | 113 |
| | 1.56" - 40mm | 6.8K | 469 | 18.7 | 71 | 37.4 | 142 | 46.7 | 177 |
| | 1.75" - 44mm | 5.3K | 366 | 23.4 | 89 | 46.9 | 178 | 58.6 | 222 |
| TY-375S at 250HP | 1.06" - 26mm | 15K | 1034 | 8.6 | 33 | 17.3 | 65 | 21.6 | 82 |
| | 1.25" - 32mm | 14K | 966 | 12.0 | 45 | 23.9 | 91 | 29.9 | 113 |
| | 1.56" - 40mm | 8.5K | 586 | 18.7 | 71 | 37.4 | 142 | 46.7 | 177 |
| | 1.75" - 44mm | 6.7K | 462 | 23.4 | 89 | 46.9 | 178 | 58.6 | 222 |
| TY-375S at 300HP | 1.25" - 32mm | 15K | 1034 | 12.0 | 45 | 23.9 | 91 | 29.9 | 113 |
| | 1.56" - 40mm | 10K | 690 | 18.7 | 71 | 37.4 | 142 | 46.7 | 177 |
| | 1.75" - 44mm | 8K | 552 | 23.4 | 89 | 46.9 | 178 | 58.6 | 222 |

Note: All flows are based on 100% volumetric efficiency. Consult with factory for delivery.

Stroke: 3.75" / 95 mm • Max. Speed: 515 RPM • Weight: 2,100 lbs. / 953 Kg

TY-375S

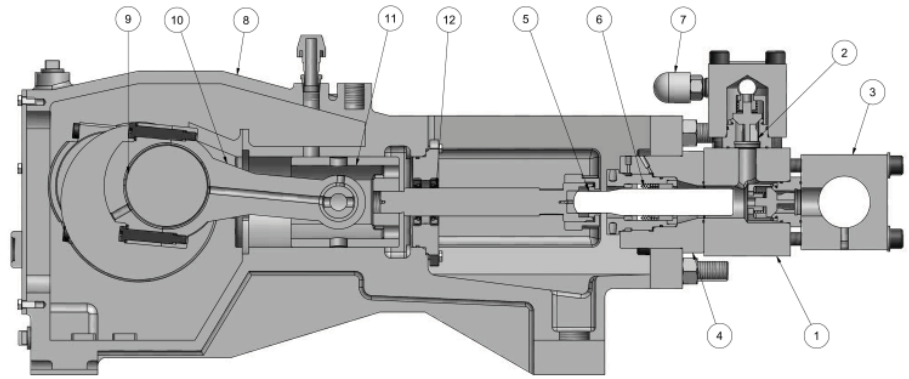

Fluid End

1. Fluid Cylinder Body: Machined from a solid block of stainless steel. Internal cylinder bore volume is minimized. Flanged discharge ports: 1" NPT (F).
2. Valves: Stainless steel, wing-guided and spring-loaded for positive closing. Valve seats have a straight shoulder. Both are machined, heat-treated and ground with replaceable elastomers seals.
3. Suction Manifold: Anodized aluminum with flanged 3" NPT (F) ports. Also available in stainless for salt water applications.
4. Stuffing Boxes: Machined from heat treated stainless steel.
5. Plungers: Colmonoy coated stainless steel or solid tungsten carbide.
6. Plunger Packing: Cartridge assembly is easily installed from the pump cradle. Packing consists of multiple elements, chevron style and are self-adjusting. Force fed water provides lubrication and cooling.
7. Pressure Relief: Pressure safety head assembly (rupture disc), integrally mounted in the fluid cylinder. Relief valve and pressure gauge are included.

Power End

8. Power Frame: Manufactured from a single piece casting of high strength gray cast iron.
9. Crankshaft: Single extended alloy steel with tapered roller bearings to minimize side thrust load.
10. Connecting Rods: Ductile iron with automotive type split insert bearings.
11. Crossheads: Large, piston type constructed of gray iron.
12. Diaphragm Seal Plates: Installed with o-rings and neoprene oil seals.

Bearings and crossheads are oil lubricated with a combined splash gravity system that insures adequate circulation at speeds as low as 200 RPM.

Dimensions:

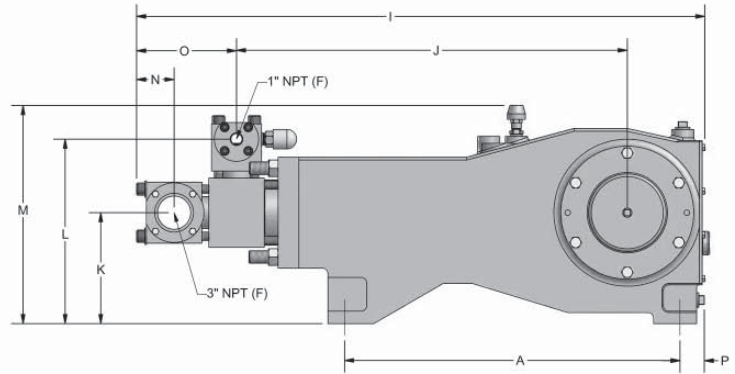
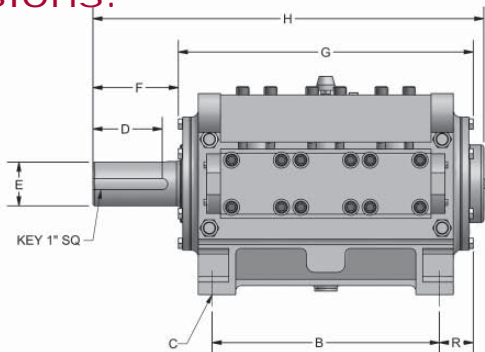

| | A | B | C | D | E | F | G | H | I | J | K | L | M | N | O | P | R |
|-----|--------------------------------|--------------------------------|------|-----|-----|-------------------------------|--------------------------------|--------------------------------|--------------------------------|--------------------------------|-----|--------------------------------|----------------------------------|-------------------------------|-----|-------------------------------|----|
| In. | 30 ¹ / ₄ | 20 ¹ / ₂ | 1.06 | 6 | 4 | 7 ³ / ₄ | 26 ⁵ / ₈ | 35 ¹ / ₄ | 51 ¹ / ₄ | 35 ¹ / ₄ | 10 | 16 ⁵ / ₈ | 19 ¹¹ / ₁₆ | 3 ³ / ₈ | 9 | 2 ¹ / ₄ | 3 |
| mm | 768 | 521 | 27 | 152 | 102 | 197 | 676 | 895 | 1302 | 895 | 254 | 422 | 500 | 86 | 229 | 57 | 76 |

GARDNER DENVER WATER
JETTING SYSTEMS, INC.



GARDNER DENVER WATER JETTING SYSTEMS, INC.

Partek • Liqua-Blaster • CRS Power Flow • Jetting Systems • American Water Blaster