

The BV Series

# WORKS BEST UNDER PRESSURE

BV1600  
Direct Drive



BV900  
Direct Drive



**RAMTEQ**<sup>®</sup>  
QUALITY PRESSURE WASHERS

## Best Engineered

### VERSATILITY

The BV gasoline engine series are the most portable and maneuverable pressure washers in the industry. Versatility with features such as interchangeable wheel configurations allows you to accommodate your individual needs. These products are ideal for industrial and commercial cleaning applications.

### SERVICEABILITY

RAMTEQ's top-quality, durable construction provides years of reliability. Designed with the user in mind, RAMTEQ's modular technology supports low operational costs through easy, efficient and effective service and upgrade paths. RAMTEQ products are designed and built for performance, dependability and low total cost of ownership.

### VALUE

With RAMTEQ, you get more than just top-of-the-line products with the features and conveniences you want. You also get unmatched customer service and support from a company dedicated to innovative engineering and customer satisfaction.

NO WONDER CUSTOMERS  
CHOOSE RAMTEQ.

Its Simply Done Right.<sup>®</sup>



**PUMP SAVER VALVE**  
RELIABILITY—SAFETY

**MODULAR DESIGN**  
SERVICEABILITY

**WAYNE® BURNER**  
RELIABILITY

**ALTERNATE WHEEL CONFIGURATIONS**  
PORTABILITY—MANEUVERABILITY

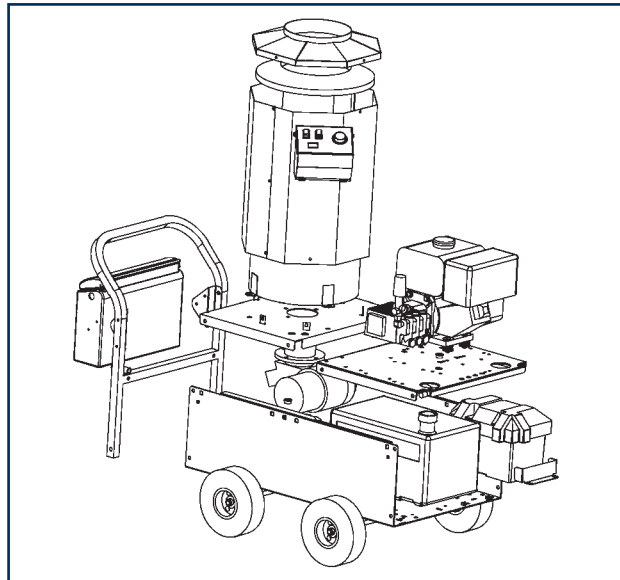

**SPLIT STAINLESS-STEEL OUTER COIL WRAP**  
RELIABILITY

**GENERAL® DIRECT DRIVE TRIPLEX PLUNGER PUMPS**  
RELIABILITY

**CROSS-LINKED POLYETHYLENE FUEL TANK**  
SAFETY—DURABILITY

**FULL CHASSIS UNDERCARRIAGE**  
SAFETY

## SPECIFICATIONS

	<b>900 SERIES</b>	<b>1100 SERIES</b>	<b>1300 SERIES</b>	<b>1600 SERIES</b>
<b>HORSEPOWER</b>	9.0 HP	11.0 HP	13.0 HP	16 HP
<b>WATER PUMP VOLUME</b>	3.5 GPM/13.3 LPM	3.5 GPM/13.3 LPM	4.0 GPM/15.2 LPM	4.0 GPM/15.2 LPM
<b>OPERATING PRESSURE</b>	2500 PSI/172.4 BARS	3000 PSI/206.8 BARS	3000 PSI/206.8 BARS	4000 PSI/275.6 BARS
<b>BTU<sup>5</sup> PER HOUR</b>	325,000	325,000	350,000	350,000
<b>DIMENSIONS</b>	47.8"L, 32.3"W, 45.4"H	47.8"L, 32.3"W, 45.4"H	47.8"L, 32.3"W, 45.4"H	47.8"L, 32.3"W, 45.4"H
<b>GROSS SHIPPING WEIGHT</b>	530 LBS	540 LBS	540 LBS	560 LBS

THE BV1600 4.6 GPM @ 3500 PSI IS A CAT GEAR DRIVE PUMP

## STANDARD FEATURES

- **DIRECT DRIVE TRIPLEX PLUNGER PUMP**—GENERAL®, CAT®
- **BURNER** - WAYNE®, 12 VOLT WITH DROPOUT TIMER  
OIL FIRED (NO. 1 & NO. 2 DIESEL, KEROSENE, NO. 1 HOME HEATING OIL)
- **ENGINES** - BRIGGS VANGUARD®, HONDA®
- **WHEEL CONFIGURATIONS**  
SOLID CORE ROTATING FRONT CASTERS  
WITH SOLID CORE FIXED REAR CASTERS  
SOLID CORE FRONT ROTATING CASTERS  
WITH REAR SPLIT RIM PNEUMATIC AXLE WHEELS  
SPLIT RIM PNEUMATIC AXLE WHEELS  
WITH COLLARS FRONT AND REAR
- **DOWNSTREAM CHEMICAL INJECTION**
- **SPLIT STAINLESS-STEEL OUTER COIL WRAP**
- **STEEL CHASSIS**  
WITH TEXTURED POLYESTER POWDER COAT
- **FUEL TANK, 9 GALLON CAPACITY**  
WITH INTEGRATED CAP GAUGE AND STAINLESS-STEEL DIAL INDICATOR
- **TRIGGER GUN CONTROL**  
WITH DUAL LANCE WAND
- **NOZZLES (0°, 15°, 25°, 40°)**
- **50' HOSE — 3/8" ID**  
INSULATED SINGLE BRAID HOSE  
WITH SWIVEL CONNECTOR
- **COIL: SCHEDULE 80**
- **ADJUSTABLE THERMOSTAT**

*Ramtec develops pressure washers with one thing in mind — you. The result is a series of products incorporating leading technologies, highest-quality components and unparalleled construction. These products are engineered for reliability, performance and value. Another series of products Simply Done Right.™*

We continue to evolve and enhance our product offerings and therefore pictures, features and specifications reflected on this brochure may vary slightly from current product. These may also vary slightly based on component and manufacturing tolerances. See authorized distributors for manufacturer installed options.

**FLORIDA WATER BLAST, INC.**  
12995 Automobile Blvd. Clearwater, FL 33762  
1-800-966-0614 www.floridawaterblast.net