

The DV Series

WORKS BEST UNDER PRESSURE



DV1900
w/ Dual
Diesel Tanks

RAMTEQ[®]
QUALITY PRESSURE WASHERS

Best Engineered

VERSATILITY

The DV series of pressure washers offers a rugged 1¼ square tubular steel chassis. This chassis provides a stable skid mount configuration and is adaptable to a portable configuration with an optional wheel kit. These products are ideal for industrial and commercial cleaning applications.

SERVICEABILITY

RAMTEQ's top-quality, durable construction provides years of reliability. Designed with the user in mind, RAMTEQ's modular technology supports low operational costs through easy, efficient and effective service and upgrade paths. RAMTEQ products are designed and built for performance, dependability and low total cost of ownership.

VALUE

With RAMTEQ, you get more than just top-of-the-line products with the features and conveniences you want. You also get unmatched customer service and support from a company dedicated to innovative engineering and customer satisfaction.

NO WONDER CUSTOMERS
CHOOSE RAMTEQ.
Its Simply Done Right.™



RUGGERINI DIESEL ENGINE
RELIABILITY

**BELT DRIVE TRIPLEX
PLUNGER PUMP—GENERAL®**
RELIABILITY

**1¼" SQUARE TUBULAR
STEEL FRAME**
SERVICEABILITY—RELIABILITY

**CROSS-LINKED
POLYETHYLENE FUEL TANKS**
SERVICEABILITY—RELIABILITY

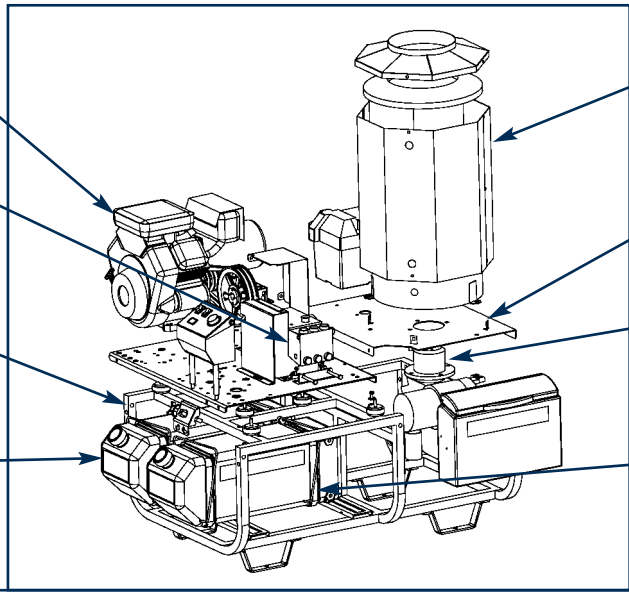

**SPLIT STAINLESS STEEL
OUTER COIL WRAP**
RELIABILITY

MODULAR DESIGN
SERVICEABILITY

WAYNE® BURNERS
RELIABILITY

**STAINLESS-STEEL FUEL TANK
TORSION BARS**
SAFETY—DURABILITY

SPECIFICATIONS

ENGINE HP
WATER PUMP VOLUME
OPERATING PRESSURE
BTUS PER HOUR
DIMENSIONS
GROSS SHIPPING WEIGHT

1900 SERIES
19.1 HP
5.2 GPM/19.7 LPM
3500 PSI/241.3 BARS
390,000
47.5"L, 32.5"W, 44.9"H
630 LBS

STANDARD FEATURES

- BELT DRIVE TRIPLEX PLUNGER PUMP—GENERAL®
- BURNER - WAYNE®
OIL FIRED (NO. 1 & NO. 2 DIESEL, KEROSENE, NO. 1 HOME HEATING OIL)
- ENGINE - 19HP RUGGERINI
- SPLIT STAINLESS-STEEL OUTER COIL WRAP
- 1¼" SQUARE TUBULAR STEEL CHASSIS
WITH TEXTURED POLYESTER POWDER COAT
- POLYETHYLENE FLOAT TANK
- COIL: SCHEDULE 80, ANCHORED
- GENERATOR WITH WAYNE® 115V BURNER
- HOUR METER
- 50' HOSE — 3/8" ID INSULATED DOUBLE BRAID HOSE
WITH SWIVEL CONNECTOR
- UPSTREAM CHEMICAL METERING WITH
POLYETHYLENE FLOAT TANK
- LOW CENTER OF GRAVITY
- 10" EXHAUST STACK
- 1" INSULATION BLANKET
- COMPRESSED FIBER INSULATION CAP
- MODULAR PLATFORM DESIGN
- HEAVY DUTY POWERPLATE SHOCK MOUNTS
- ALL SHARP CORNERS CHAMFERED FOR SAFETY
- HIGH TEMPERATURE TRI-LINGUAL LEXAN LABELS
- DUAL TANKS, 10 GALLON CAPACITY
CROSSLINK POLYETHYLENE
WITH INTEGRATED CAP GAUGE AND
STAINLESS-STEEL DIAL INDICATOR
- MOLDED IN FUEL TANK FITTINGS
- SAME SIDE FUEL FILL LOCATION
- TRIGGER GUN CONTROL
WITH SINGLE LANCE WAND
- NOZZLES (0°, 15°, 25°, 40°) QUICK CONNECT
WITH MOUNTING RECEPTACLES
- ADJUSTABLE THERMOSTAT
- WATER RESISTANT CONTROL SWITCHES
- STEEL & BRASS FITTINGS
- STEEL PULLEYS & BUSHINGS
- PUMP BELT TENSION ADJUSTER
- BEND RESTRICTORS BOTH HOSE ENDS
- STEEL PULLEYS & BUSHINGS
- JIC FITTINGS
- CAPTIVE HARDWARE
- METAL CONTROL BOX
- STAINLESS STEEL TORSION BARS
- STAINLESS STEEL BOLTS AND WASHERS

*Ramteq develops
pressure washers with
one thing in mind — you.
The result is a series of
products incorporating
leading technologies,
highest-quality
components and
unparalleled construction.
These products are
engineered for
reliability, performance
and value. Another series
of products
Simply Done Right.™*

We continue to evolve and enhance our product offerings and therefore pictures, features and specifications reflected on this brochure may vary slightly from current product. These may also vary slightly based on component and manufacturing tolerances. See authorized distributors for manufacturer installed options.